

GALASSI&ORTOLANI



Pinch Valves
Diaphragm Valves

Pinch Valves

The Answer To Problems Of :
Corrosion, Abrasion, Granulated Materials, Powders, Sludge, Gas Etc

Manual and pneumatic operated pinch valves do not incorporate any stuffing box and are leak tight on all liquids, slurries, granular materials, powders, pastes, gases, acids etc.. Sleeve (internal rubber) is supported during opening and closing, and is easily replaceable without any special tools. The wide range of available elastomer materials enables an appropriate selection for each application and is a guarantee of perfect resistance to corrosion and abrasion

The unique construct of the valve ensure that the flow media does not touch the metallic surface of the valve. Pinch valves can be used to control the flow of the media unlike other on/off valves and this helps in managing the flow of the media without any loss of head.

Product Features

- Straight through way
- Sizes from 1" through 12"
- Flanged valves according to UNI PN 10 and ANSI / ASME 150#
- Manual, Pneumatic and Electric

Performance Features

- No loss of head
- Faultless sealing on liquids, fluid suspensions, granulated materials, powders, sludge, gas, etc.
- No packing
- Quick and easy replacement of sleeve, no special tooling required
- Sleeve supported during opening and closing: hence the possibility of under vacuum operation
- No maintenance
- Long durability
- Threaded spindles and side tie rods in Stainless Steel
- Cylinders in Aluminium and specially treated cylinder springs on Pneumatic models
- Powder coated valve bodies

Body Materials

- Cast Iron GJL 250 / Cast Iron A126
- Spheroidal Graphite Cast Iron GGG40 / Ductile Iron ASTM A 395

Materials of Sleeves

- Natural rubber
- White natural rubber
- Neoprene
- EPDM
- Viton
- Butyl
- Nitrile
- Hypalon
- Silicone
- Neoprene Silicon (mixed)

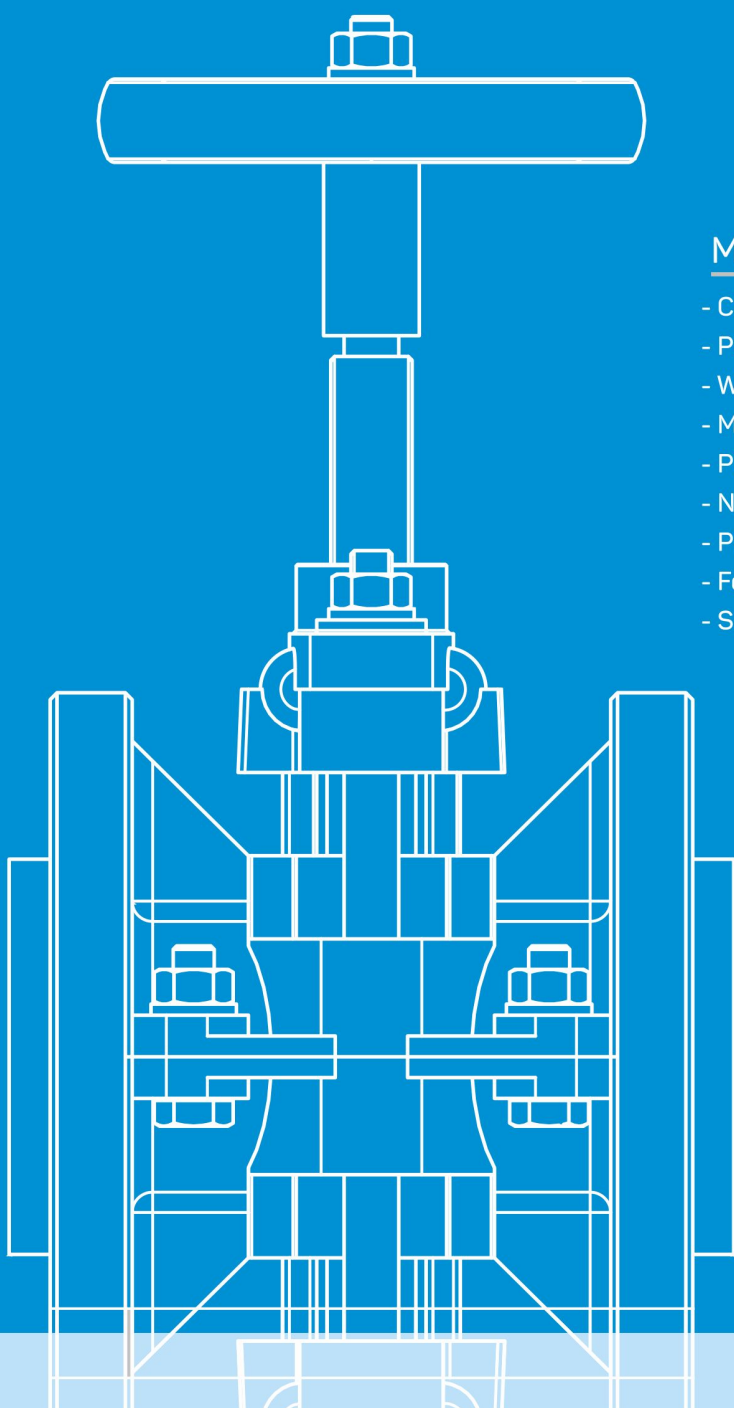

Major Markets Served

- Chemical Process
- Power Generation
- Water Treatment
- Mining
- Pulp & Paper
- Nuclear
- Pharmaceutical
- Food & Beverage
- Sugar

Model GS 21

PINCH VALVES

GS 21 is G&O's high pressure Closed design Pinch Valve.

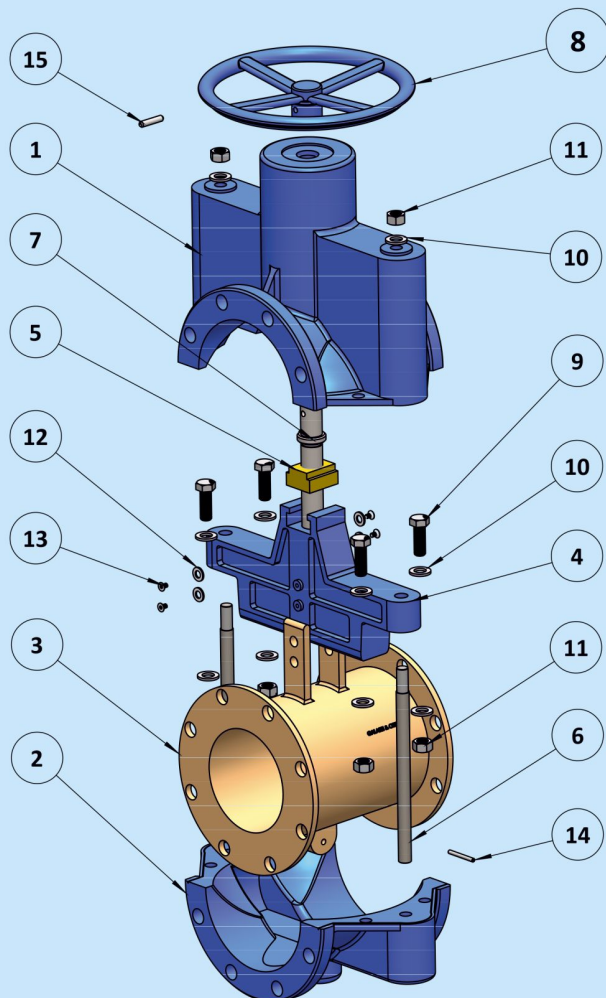

S.No	Description	Material
1	Upper Body	Cast Iron
2	Lower Body	Cast Iron
3	Sleeve	Natural Rubber
4	Tampon	Wcb/ductile Iron
5	Bush	Brass
6	Tie Rod	Stainless Steel
7	Leadscrew	Stainless Steel
8	Handwheel	Aluminium
9	Hexagonal Bolt	Carbon Steel
10	Plain Washer	Carbon Steel
11	Hexagonal Nut	Carbon Steel
12	Plain Washer	Carbon Steel
13	Socket Head Screw	Carbon Steel
14	Slotted Spring Pin	Spring Steel
15	Slotted Spring Pin	Spring Steel

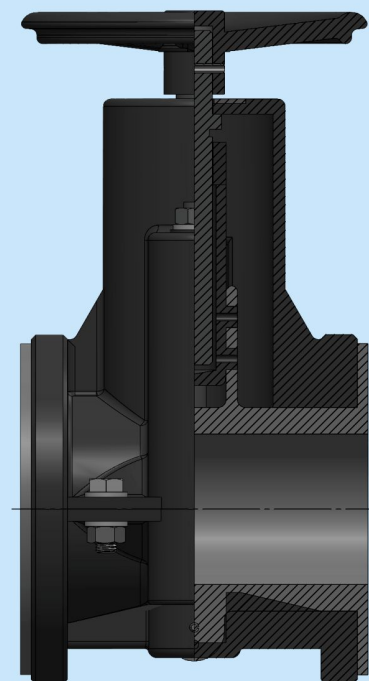
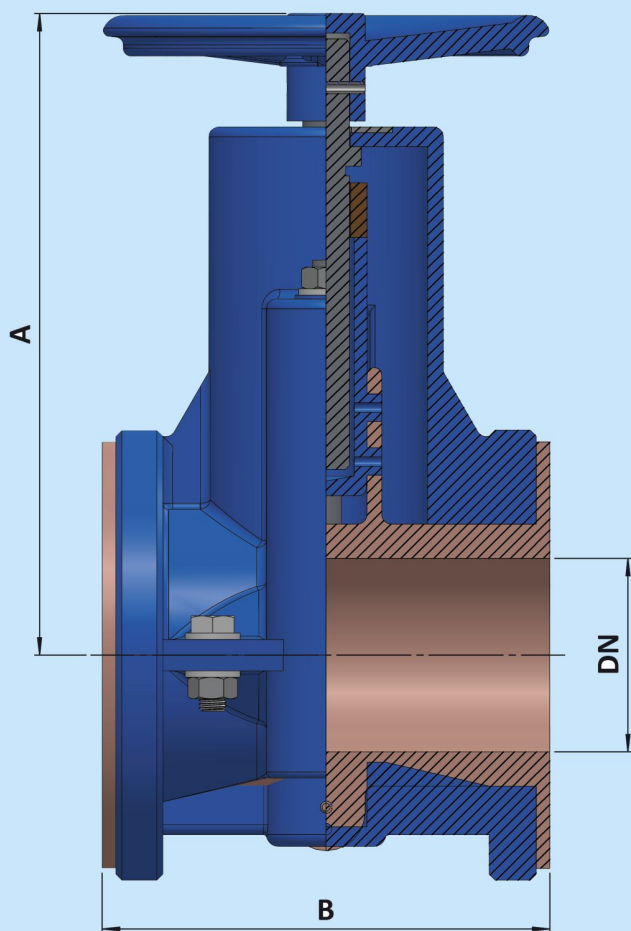

Pressure Details UNI_1284

DN ("/mm)	Working Pressure Kg / Cm ²	Working Pressure In Psi
1"/25	10	145
1½"/40	10	145
2"/50	10	145
2½"/65	10	145
3"/80	10	145
4"/100	10	145
5"/125	10	145
6"/150	10	145
8"/200	8.5	125
10"/250	7	100
12"/300	7	100

Weight

LBS	Kgs
10	4.5
19.84	9
30.86	14
39.68	18
50.7	23
81.57	37
105.82	48
132.28	60
187.39	85
220.46	100
275.58	125

Dimensions in Inches / MM

DN	A	B
1" / 25	5.31/135	5.51/140
1½" / 40	7/178	6.5/165
2" / 50	8.15/207	7.01/178
2½" / 65	8.74/222	7.38/187.5
3" / 80	9.25/235	8/203
4" / 100	13/330	9.015/229
5" / 125	13.5/343	9.84/250
6" / 150	14.64/372	10.47/266
8" / 200	21.26/540	15.98/406
10" / 250	21.65/550	20/508
12" / 300	24.6/625	23.94/608



Actuators & Accessories

Actuators

- Hand Wheel
- Gear Box
- Pneumatic
 - Single Acting
 - Double Acting
- Electrical

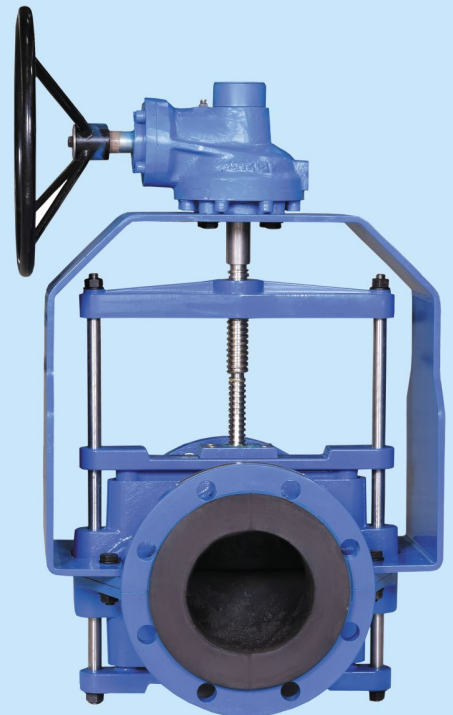

Accessories

- Solenoid Valves
- Positioner
- Limit Switch
- AFRL
- Air Lock Relay
- Volume Booster
- Proximity Switch / Sensors etc ...



TYPICAL RUBBER SLEEVE SELECTION AND APPLICATION

Material	Application	Temp. range °C	Hardness in Shore-A
Natural rubber	Mildly acid resistant	-30 to 80	65 – 75
Natural rubber	Abrasion resistant	-30 to 80	60 – 70
Natural rubber	Highly abrasion resistant	-30 to 80	50 – 60
White natural rubber	Food & Pharmaceuticals	-10 to 80	55 – 65
Neoprene rubber	Diluted acid resistant	-25 to 95	65 – 75
Neoprene rubber	Water treatment	-25 to 95	60 – 70
Neoprene rubber	Caustic soda	-25 to 95	60 – 70
Butyl rubber	Steam sterilisation	-25 to 115	60 – 70
Nitrile rubber	Oils & Fats	-10 to 90	65 – 75
Hypalon rubber	Acid resistant	-15 to 110	60 – 70
Epdm rubber	Radio active materials	-30 to 128	60 – 70
Viton rubber	Aromatics chlorine	-10 to 178	60 – 70
Viton rubber	High temperatures	-10 to 178	60 – 70
Silicone rubber	High temperatures	-100 to 220	60 - 70

Hypalon® & Viton® are trademarks of Dupont

